

STAGE 1A CONSTRUCTION ACTIVITIES
 STAGE 1A CONSTRUCTION ACTIVITIES FOR TREE CLEARING ONLY.
 (i) INSTALLATION OF TEMPORARY CONSTRUCTION ENTRANCES #1 AND #2
 (ii) INSTALLATION OF STAGE 1A TREE PRESERVATION FENCING
 (iii) INSTALLATION OF SELECT EROSION CONTROL MEASURES AS DIRECTED ON SITE BY PROJECT ADMINISTRATOR.
 (iv) TREE CUTTING AND REMOVAL IN STAGE 1A AREAS ONLY. WINTER/SPRING 2010.
 (v) THE PROVISIONS OF THE SITE SPECIFIC EROSION AND SEDIMENT CONTROL MONITORING AND MITIGATION PROGRAM SHALL BE STRICTLY FOLLOWED AT ALL TIMES.

STAGE 1B CONSTRUCTION ACTIVITIES
 STAGE 1B CONSTRUCTION ACTIVITIES FOR TREE CLEARING ONLY.
 (i) INSTALLATION OF STAGE 1B TREE PRESERVATION AND SEDIMENT CONTROL FENCE.
 (ii) REMOVAL OF STAGE 1A TREE PRESERVATION AND SEDIMENT CONTROL FENCE BETWEEN STAGE 1A AND 1B WORK AREAS.
 (iii) TREE CUTTING AND REMOVAL IN STAGE 1B AREAS ONLY. FALL/WINTER 2010

STAGE 1B-2 CONSTRUCTION ACTIVITIES
 STAGE 1B-2 CONSTRUCTION ACTIVITIES FOR TREE CLEARING ONLY.
 (i) INSTALLATION OF TEMPORARY CONSTRUCTION ENTRANCE #3. (IF NOT PREVIOUSLY INSTALLED)
 (ii) INSTALLATION OF STAGE 1B-2 TREE PRESERVATION AND SEDIMENT CONTROL FENCE.
 (iii) WORK IN AREA 1B-2 SHALL BE CARRIED OUT IN FALL/WINTER 2010.

STAGE 1C CONSTRUCTION ACTIVITIES
 STAGE 1C CONSTRUCTION ACTIVITIES FOR TREE CLEARING ONLY.
 (i) INSTALLATION OF STAGE 1C SEDIMENT CONTROL FENCE.
 (ii) REMOVAL OF STAGE 1B TREE PRESERVATION AND SEDIMENT CONTROL FENCE BETWEEN STAGE 1B AND 1C WORK AREAS.
 (iii) WORK IN AREA 1C IS SCHEDULED FOR FALL OF 2011. (FINAL EARTHWORKS STAGE)

CONTRACTOR TO PROVIDE SIGNAGE AND TRAFFIC CONTROL AS PER OTM. SITE ACCESS AND PROJECT NOTICE SIGNAGE TO BE INSTALLED AND MAINTAINED AS DIRECTED BY PROJECT ADMINISTRATOR.
 TEMPORARY SWALE CROSSING WITH 14m-6000 CSP
 ACCESS #3
 INSTALL TEMPORARY CONSTRUCTION ENTRANCE IF REQUIRED, AS DIRECTED BY THE PROJECT ADMINISTRATOR

SEDIMENT CONTROL FENCE TO BE INSTALLED PRIOR TO TOPSOIL STRIPPING, AND REMAIN UNTIL STAGE 1B-2 TREE REMOVAL
 EXISTING BUTTERNUT TREES TO REMAIN UNTIL FUTURE REMOVAL IS APPROVED BY MINISTRY OF NATIONAL RESOURCES. MAINTAIN 30m BUFFER ZONE AROUND EACH RETAINABLE TREE UNTIL MINISTRY OF NATIONAL RESOURCES APPROVAL IS OBTAINED.

TREE PRESERVATION FENCE TO BE INSTALLED AT LIMIT OF FAIRWAY LINE. TO BE FINALIZED IN FIELD.

SEDIMENT CONTROL FENCE TO BE INSTALLED PRIOR TO STAGE 1B TREE CLEARING

EXISTING BUTTERNUT TREES TO REMAIN UNTIL FUTURE REMOVAL IS APPROVED BY MINISTRY OF NATIONAL RESOURCES. MAINTAIN 30m BUFFER ZONE AROUND EACH RETAINABLE TREE UNTIL MINISTRY OF NATIONAL RESOURCES APPROVAL IS OBTAINED.

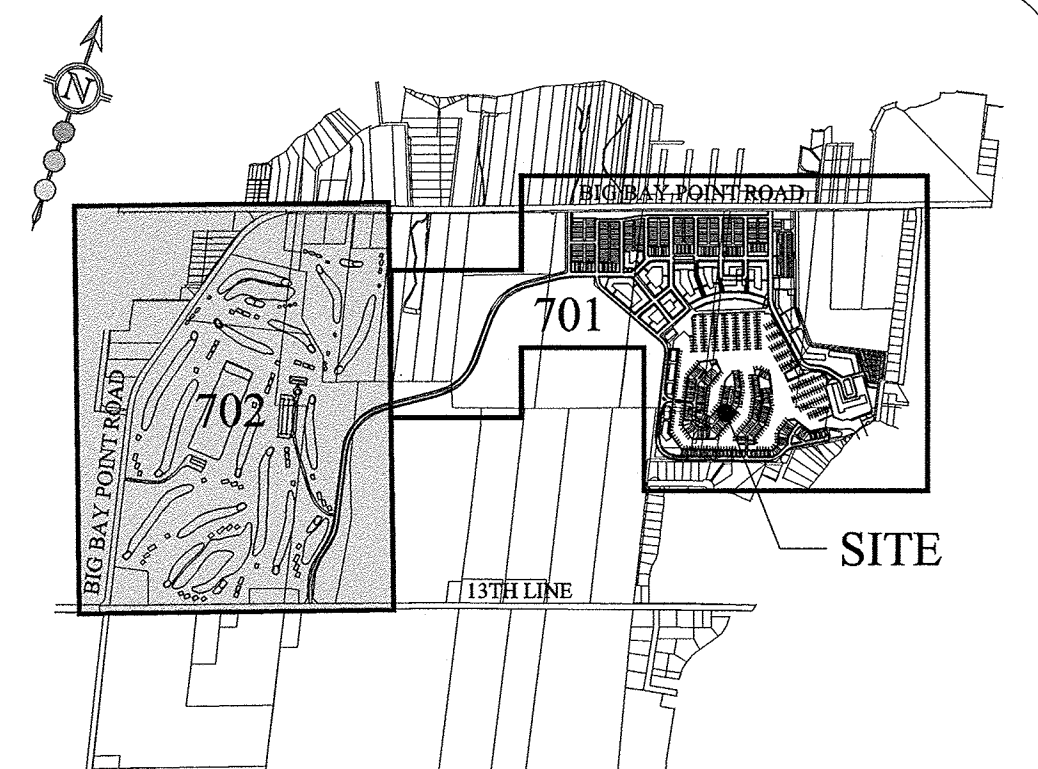

KEY PLAN
N.T.S.

LEGEND:

- PROPERTY BOUNDARY
- - - TREE PRESERVATION FENCE (STAGE 1A)
- TREE PRESERVATION FENCE (STAGE 1B)
- . - . TREE PRESERVATION FENCE (STAGE 1B-2)
- - - - TREE PRESERVATION FENCE (STAGE 1C)
- SEDIMENT CONTROL FENCE
- EXISTING CONTOUR
- ROCK CHECK DAM
- TEMPORARY CONSTRUCTION ENTRANCE
- TEMPORARY SWALE
- × 224.00(EX) EXISTING ELEVATION
- EXISTING TREE LINE
- STAGE 1A TREE REMOVAL
- STAGE 1B TREE REMOVAL
- STAGE 1B-2 TREE REMOVAL
- STAGE 1C TREE REMOVAL
- PROPOSED CONTRACTOR REFUELLING/MAINTENANCE AREA
- PROPOSED TREE PROCESSING AREA

- GENERAL NOTES (STAGE 1):**
- THE OWNER IS RESPONSIBLE FOR OBTAINING ALL NECESSARY APPROVALS FROM THE TOWN PRIOR TO ANY SITE ALTERATION ACTIVITY.
 - PRIOR TO COMMENCEMENT OF ANY ACTIVITY ON SITE, TOPSOIL STRIPPING, TREE REMOVAL, EROSION & SEDIMENT CONTROL (ESC) MEASURES, TREE PROTECTION FENCING, MUST BE INSTALLED AND APPROVED BY THE DIRECTOR OF ENGINEERING AND/OR PROJECT ADMINISTRATOR. ADDITIONAL ESC MEASURES, IF REQUIRED, SHALL BE INSTALLED AS DIRECTED BY THE DIRECTOR OF ENGINEERING AND/OR PROJECT ADMINISTRATOR. THE ESC MEASURES SHALL REMAIN IN PLACE UNTIL DIRECTED BY THE DIRECTOR OF ENGINEERING AND/OR PROJECT ADMINISTRATOR FOR THEIR REMOVAL.
 - TREE PRESERVATION FENCING TO BE INSTALLED AT THE DIRECTION OF THE SITE ARBORIST IN LOCATIONS DELINEATED ON THE TREE INVENTORY AND CLEARING PLANS PREPARED BY SCHOLLEN AND COMPANY.
 - NO CONSTRUCTION ACTIVITY OR MACHINERY SHALL BE ALLOWED BEYOND THE TREE PRESERVATION/SEDIMENT CONTROL/SNOW FENCE OR LIMITS OF THE DEVELOPMENT.
 - THE CONTRACTOR IS RESPONSIBLE TO IMPLEMENT DUST CONTROL MEASURES AND CONSTRUCTION PRACTICE GUIDELINES AS APPROVED BY TOWN / LSBCA.
 - THE CONTRACTOR IS RESPONSIBLE FOR MAINTAINING ALL ESC MEASURES IN WORKING CONDITIONS AT ALL TIMES TO THE SATISFACTION OF THE DIRECTOR OF ENGINEERING AND/OR PROJECT ADMINISTRATOR. THE CONTRACTOR SHALL ROUTINELY INSPECT ALL ESC DEVICES AT A MINIMUM OF ONCE A WEEK AND AFTER EACH RAINFALL EVENT GREATER THAN 10mm TO ENSURE THAT ESC MEASURES ARE IN PROPER WORKING CONDITIONS. ANY DAMAGES MUST BE REPAIRED WITHIN 24 HOURS. DAMAGES INVESTIGATED AND REPAIR PROCEDURES IMPLEMENTED MUST BE LOGGED AND RETAINED ON-SITE FOR REVIEW BY A QUALIFIED EROSION AND SEDIMENT CONTROL INSPECTOR TO ASCERTAIN THE EFFECTIVENESS OF THE REPAIRS. (I.E. ARE THEY RECURRING TOO FREQUENTLY, INDICATING A NEW STRATEGY IS REQUIRED, OR SUBSTANDARD MATERIALS USED ETC.)
 - ALL CONSTRUCTION VEHICLES MUST ENTER AND EXIT THE SITE ONLY FROM THE APPROVED ACCESS ROUTES(S) AS SHOWN ON THE PLAN.
 - ALL DISTURBED GROUND LEFT ANTICIPATED TO BE INACTIVE FOR OVER 30 DAYS SHALL BE VEGETATED, SUBJECT TO WEATHER CONDITIONS, BY SEEDING OR APPROVED EQUIVALENT TO THE SATISFACTION OF THE DIRECTOR OF ENGINEERING AND/OR PROJECT ADMINISTRATOR. IF CONDITIONS ARE NOT SUITABLE FOR VEGETATION AFTER 30 DAYS, THEN AREAS ARE TO BE VEGETATED AS SOON AS POSSIBLE THEREAFTER.
 - PROCESSED WOOD CHIPS (MULCH) TO BE PLACED AS DIRECTED BY THE PROJECT ADMINISTRATOR TO REDUCE EXPOSURE OF BARE SOIL DURING THE TREE CLEARING OPERATION.
 - ALL SEDIMENT CONTROL FENCE ADJACENT TO EXISTING VEGETATION WILL REQUIRE TREE PRESERVATION SIGNAGE AT 30m INTERVALS AS PER DETAIL ON DRAWING 705

REVISIONS

No.	DESCRIPTION	DATE	BY	APPROVED
1.	FOR STAGE 1A TREE REMOVAL APPROVAL ONLY	JAN 08/10	S.S.	FEB 28/10
2.	FOR STAGE 1A GRUBBING AND GOLF COURSE TOPSOIL STRIPPING OUTSIDE OF TREAED AREAS	MAR 25/10	S.S.	
3.	SECOND SUBMISSION FOR STAGE 1A GRUBBING AND GOLF COURSE TOPSOIL STRIPPING OUTSIDE OF TREAED AREAS	MAY 06/10	S.S.	

SCS consulting group ltd
 30 CENTURIAN DRIVE, SUITE 100
 MARKHAM, ONTARIO L3R 8B8
 TEL: (905) 475-1900
 FAX: (905) 475-8335

Innisfil
 Where Opportunity Meets Prosperity
 2183 INNISFIL BEACH ROAD
 STROUD, ONTARIO L0L 2M0
 TEL: (705) 436-3710
 FAX: (705) 436-7923

BIG BAY POINT RESORT DEVELOPMENT
TREE REMOVAL CONTROL PLAN 2 - STAGES 1A, 1B AND 1C

DATE: MAY 2010 DESIGNED BY: J.P. CHECKED BY: S.M.S.
 SCALE: 1:2000 DRAWN BY: V.S. CHECKED BY: S.M.S.

APPROVED AS TO FORM IN RELIANCE UPON THE PROFESSIONAL SKILL AND ABILITY OF SCS CONSULTING GROUP LTD. CONSULTING ENGINEERS AS TO DESIGN AND SPECIFICATION.

PROJECT No: 1097
 DRAWING No: 702A

Director of Engineering Date



SEE DWG. 701A